

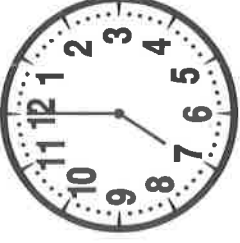
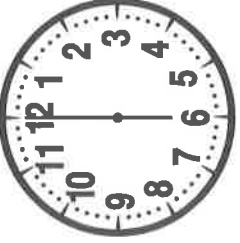
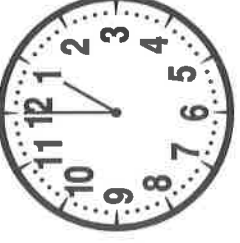
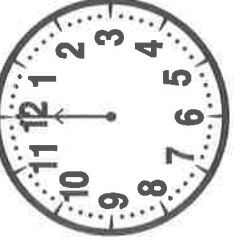

Telling Time: Writing Time

Write the time shown on these clocks.

<p>1.</p>  <p>3 o'clock</p>	<p>2.</p>  <p>_____ o'clock</p>
<p>3.</p>  <p>_____ o'clock</p>	<p>4.</p>  <p>_____ o'clock</p>
<p>5.</p>  <p>_____ o'clock</p>	 <p>Looks like it's time to read clocks!</p>

Telling Time: Drawing Clock Hands

Draw the hands on the clocks to show the time.

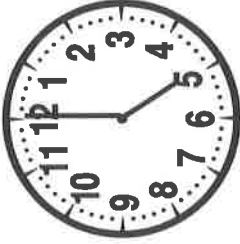
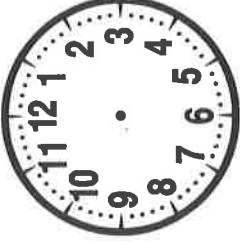
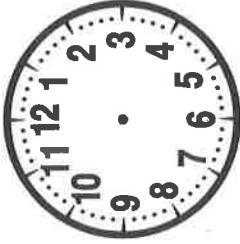
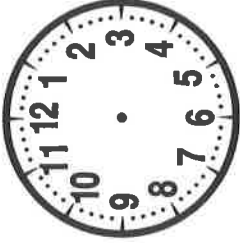
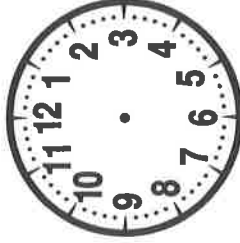
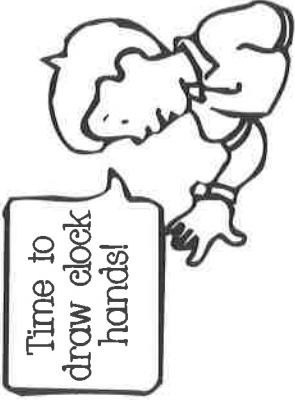
<p>1.</p>  <p>5:00</p>	<p>2.</p>  <p>8:00</p>
<p>3.</p>  <p>9:00</p>	<p>4.</p>  <p>2:00</p>
<p>5.</p>  <p>10:00</p>	 <p>Time to draw clock hands!</p>

Subtraction: Comparison

Circle all the problems that equal the number in the box.

<p>1. 8</p> <p>15 - 7 = 8</p> <p>14 - 9 =</p> <p>14 - 6 =</p> <p>18 - 10 =</p> <p>17 - 4 =</p> <p>17 - 9 =</p>	<p>2. 4</p> <p>18 - 14 =</p> <p>13 - 9 =</p> <p>15 - 8 =</p> <p>16 - 12 =</p> <p>15 - 10 =</p> <p>14 - 0 =</p>	<p>3. 10</p> <p>18 - 18 =</p> <p>18 - 8 =</p> <p>15 - 0 =</p> <p>16 - 6 =</p> <p>14 - 4 =</p> <p>13 - 3 =</p>
<p>4. 13</p> <p>16 - 3 =</p> <p>13 - 0 =</p> <p>18 - 5 =</p> <p>15 - 2 =</p> <p>16 - 2 =</p> <p>13 - 2 =</p>	<p>5. 2</p> <p>18 - 16 =</p> <p>16 - 9 =</p> <p>15 - 13 =</p> <p>14 - 8 =</p> <p>13 - 11 =</p> <p>17 - 16 =</p>	<p>6. 5</p> <p>14 - 9 =</p> <p>15 - 0 =</p> <p>13 - 1 =</p> <p>16 - 11 =</p> <p>17 - 12 =</p> <p>13 - 8 =</p>

Subtraction: Word Problem Solving

Read the story and solve the problem.

<p>1. Anna had 16 spelling words on her test. She missed 3. How many did she get right?</p> <p>16 - 3 = 13</p>	<p>2. A farmer had 15 pigs on his farm. He sold 7 of them to another farmer. How many pigs does he have left?</p> <p>_____ - _____ = _____</p>	<p>3. Ms. Jensen had 18 plants in a box. She planted 12 of them. How many plants does she have left to plant?</p> <p>_____ - _____ = _____</p>
<p>4. In our class we have 13 chairs. 6 of them are yellow. The rest are red. How many chairs are red?</p> <p>_____ - _____ = _____</p>	<p>5. Tiffany works for 17 hours. She has already been at work for 4 hours. How many hours does she have left to work?</p> <p>_____ - _____ = _____</p>	<p>6. There were 14 oranges in the basket. My friends and I ate 5 of them. How many oranges are left?</p> <p>_____ - _____ = _____</p>

Equation Practice

Find the difference. Circle all the problems that equal the number in the box.

<p>1. 4</p> <p>18 - 14 = 4</p> <p>13 - 9 =</p> <p>15 - 8 =</p> <p>16 - 12 =</p> <p>15 - 10 =</p> <p>14 - 0 =</p>	<p>2. 10</p> <p>18 - 18 =</p> <p>18 - 8 =</p> <p>15 - 0 =</p> <p>16 - 6 =</p> <p>14 - 4 =</p> <p>13 - 3 =</p>
<p>3. 0</p> <p>16 - 13 =</p> <p>16 - 16 =</p> <p>15 - 0 =</p> <p>13 - 13 =</p> <p>18 - 7 =</p> <p>17 - 17 =</p>	<p>4. 1</p> <p>17 - 16 =</p> <p>15 - 13 =</p> <p>14 - 13 =</p> <p>16 - 15 =</p> <p>18 - 17 =</p> <p>17 - 12 =</p>

Problem Solving

Write the difference for each problem below. Circle all the equations with a difference of 6.

1.
$$\begin{array}{r} 16 \\ -4 \\ \hline 12 \end{array}$$

$$\begin{array}{r} 14 \\ -10 \\ \hline 4 \end{array}$$

$$\begin{array}{r} 13 \\ -3 \\ \hline 10 \end{array}$$

$$\begin{array}{r} 18 \\ -7 \\ \hline 11 \end{array}$$

$$\begin{array}{r} 15 \\ -8 \\ \hline 7 \end{array}$$

2.
$$\begin{array}{r} 14 \\ -14 \\ \hline 0 \end{array}$$

$$\begin{array}{r} 18 \\ -6 \\ \hline 12 \end{array}$$

$$\begin{array}{r} 17 \\ -5 \\ \hline 12 \end{array}$$

$$\begin{array}{r} 14 \\ -11 \\ \hline 3 \end{array}$$

$$\begin{array}{r} 14 \\ -8 \\ \hline 6 \end{array}$$

3.
$$\begin{array}{r} 13 \\ -7 \\ \hline 6 \end{array}$$

$$\begin{array}{r} 16 \\ -7 \\ \hline 9 \end{array}$$

$$\begin{array}{r} 13 \\ -0 \\ \hline 13 \end{array}$$

$$\begin{array}{r} 18 \\ -15 \\ \hline 3 \end{array}$$

$$\begin{array}{r} 18 \\ -18 \\ \hline 0 \end{array}$$

4.
$$\begin{array}{r} 15 \\ -9 \\ \hline 6 \end{array}$$

$$\begin{array}{r} 18 \\ -1 \\ \hline 17 \end{array}$$

$$\begin{array}{r} 13 \\ -5 \\ \hline 8 \end{array}$$

$$\begin{array}{r} 16 \\ -8 \\ \hline 8 \end{array}$$

$$\begin{array}{r} 15 \\ -3 \\ \hline 12 \end{array}$$

5.
$$\begin{array}{r} 13 \\ -6 \\ \hline 7 \end{array}$$

$$\begin{array}{r} 18 \\ -9 \\ \hline 9 \end{array}$$

$$\begin{array}{r} 18 \\ -0 \\ \hline 18 \end{array}$$

$$\begin{array}{r} 17 \\ -7 \\ \hline 10 \end{array}$$

$$\begin{array}{r} 14 \\ -3 \\ \hline 11 \end{array}$$

6.
$$\begin{array}{r} 14 \\ -5 \\ \hline 9 \end{array}$$

$$\begin{array}{r} 16 \\ -9 \\ \hline 7 \end{array}$$

$$\begin{array}{r} 14 \\ -7 \\ \hline 7 \end{array}$$

$$\begin{array}{r} 14 \\ -11 \\ \hline 3 \end{array}$$

$$\begin{array}{r} 15 \\ -0 \\ \hline 15 \end{array}$$

Multiple Choice Problem Solving

in the box by the correct answer.

<p>1.</p> <p>3 <input type="checkbox"/></p> <p>7 - 4 = 2 <input type="checkbox"/></p> <p>1 <input type="checkbox"/></p>	<p>2.</p> <p>3 <input type="checkbox"/></p> <p>8 - 5 = 5 <input type="checkbox"/></p> <p>9 <input type="checkbox"/></p>	<p>3.</p> <p>6 <input type="checkbox"/></p> <p>12 - 8 = 5 <input type="checkbox"/></p> <p>4 <input type="checkbox"/></p>
<p>4.</p> <p>12 <input type="checkbox"/></p> <p>0 - 0 = 4 <input type="checkbox"/></p> <p>10 <input type="checkbox"/></p>	<p>5.</p> <p>10 <input type="checkbox"/></p> <p>10 - 10 = 9 <input type="checkbox"/></p> <p>0 <input type="checkbox"/></p>	<p>6.</p> <p>3 <input type="checkbox"/></p> <p>9 - 6 = 4 <input type="checkbox"/></p> <p>5 <input type="checkbox"/></p>
<p>7.</p> <p>9 <input type="checkbox"/></p> <p>2 - 9 = 6 <input type="checkbox"/></p> <p>3 <input type="checkbox"/></p>	<p>8.</p> <p>6 <input type="checkbox"/></p> <p>11 - 4 = 7 <input type="checkbox"/></p> <p>8 <input type="checkbox"/></p>	<p>9.</p> <p>6 <input type="checkbox"/></p> <p>8 - 2 = 8 <input type="checkbox"/></p> <p>5 <input type="checkbox"/></p>

Equation Practice

Complete the problems. Circle the ones that equal the number in the box.

<p>1.</p> <p>8</p> <p>10 - 2 = <u>8</u></p> <p>10 - 1 = <u> </u></p> <p>11 - 3 = <u> </u></p> <p>11 - 0 = <u> </u></p> <p>12 - 4 = <u> </u></p> <p>8 - 0 = <u> </u></p>	<p>2.</p> <p>10</p> <p>11 - 1 = <u> </u></p> <p>10 - 10 = <u> </u></p> <p>10 - 0 = <u> </u></p> <p>12 - 2 = <u> </u></p> <p>12 - 3 = <u> </u></p> <p>11 - 5 = <u> </u></p>
<p>3.</p> <p>4</p> <p>2 - 2 = <u> </u></p> <p>9 - 5 = <u> </u></p> <p>11 - 7 = <u> </u></p> <p>8 - 2 = <u> </u></p> <p>10 - 6 = <u> </u></p> <p>12 - 8 = <u> </u></p>	<p>4.</p> <p>5</p> <p>11 - 6 = <u> </u></p> <p>9 - 4 = <u> </u></p> <p>7 - 2 = <u> </u></p> <p>10 - 3 = <u> </u></p> <p>8 - 3 = <u> </u></p> <p>12 - 7 = <u> </u></p>

We love this math stuff!



Did you see my pet cat?

I did see a black cat.

My cat is black.

I saw a big black cat.

My cat is big and black.

This cat ran fast.

My cat can run fast.

This cat had spots.

My pet cat has spots.

It was a fat cat.

My cat is not fat.

My cat is a thin cat.

That was not my cat.

I did not see your cat.

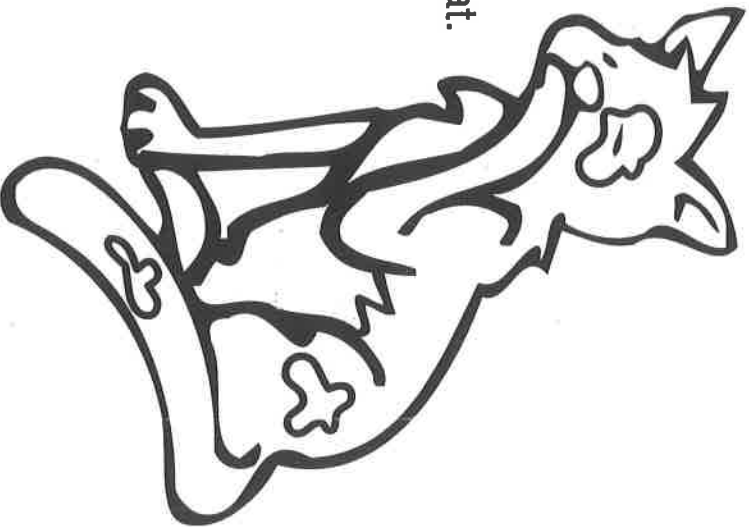

1. What color is the pet cat? (circle your answer)

blue brown black gray

2. Fill in the blanks below.

My cat is _____. (little, big)

It can _____ fast. (run, ran)

It _____ spots. (has, is)

My cat is _____. (fat, thin)

3. Circle the words that rhyme with cat.

hat black mat fast

4. Do you have a cat? What does it look like?

Hunting For Home

Can you help these animals safely find their way home? Each animal takes a different path in the maze below. Use a different color to trace each animal's path back home to its habitat.

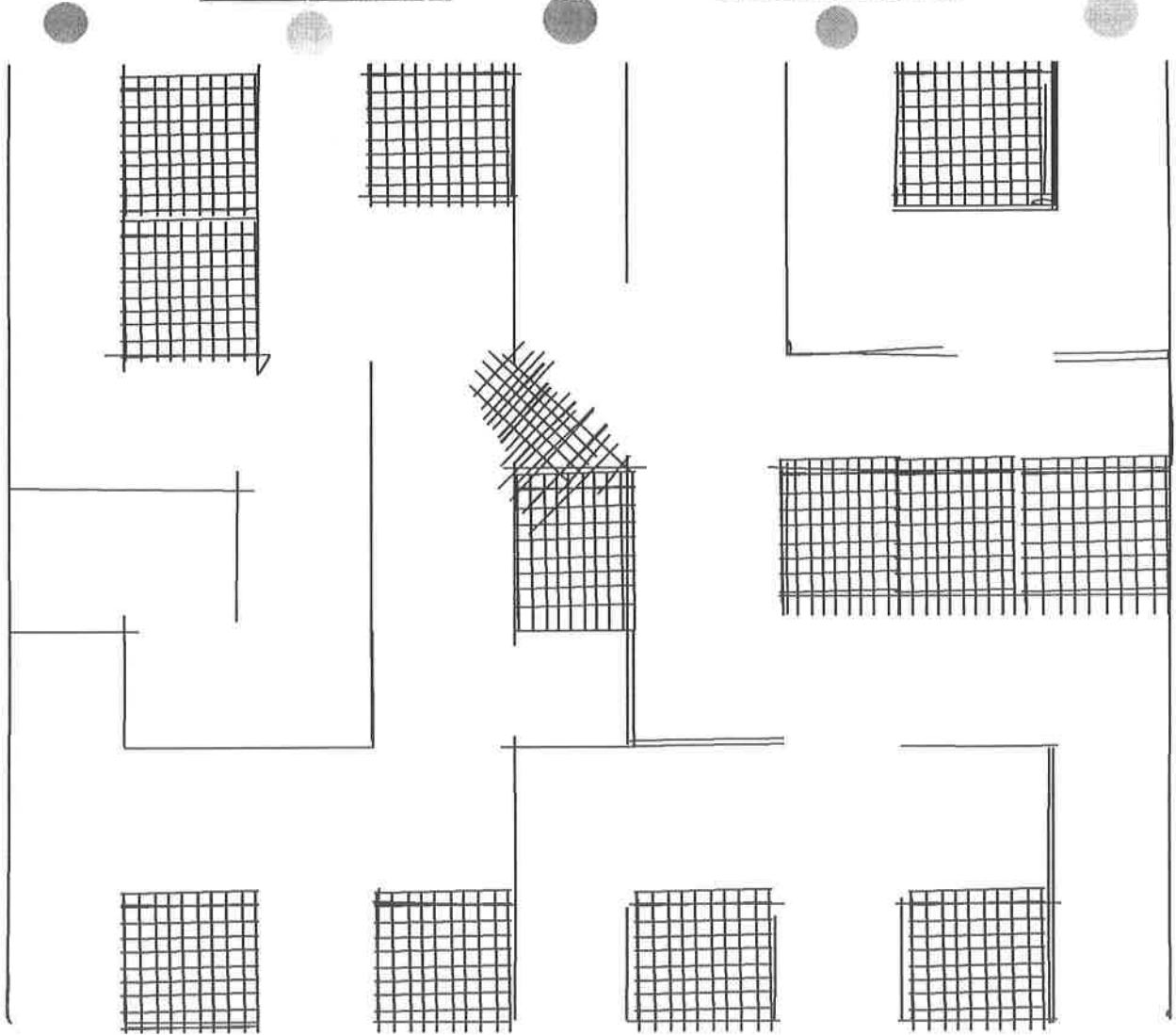
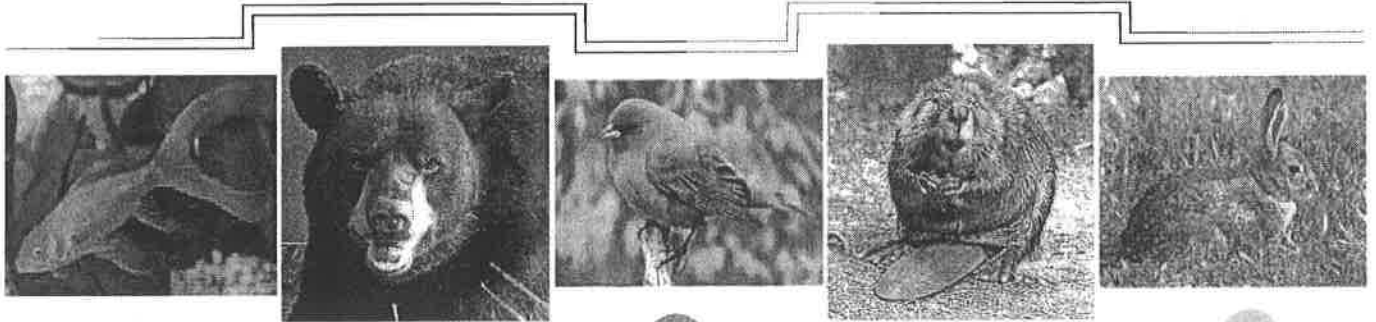

What's for dinner?

All living things need food and water in order to survive!

Look at each animal below. What might these animals eat in order to survive and thrive? Draw your ideas inside the boxes.

squirrel



snake



horse



shark

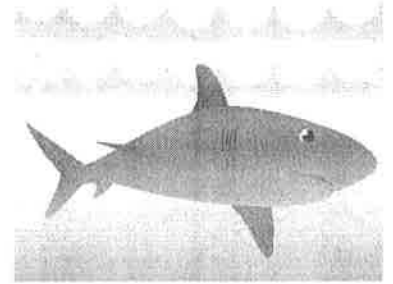

--	--	--	--

butterfly



lion



puppy



frog



--	--	--	--

What, Oh What Should I Wear?

Different animals wear different types of body coverings. Can you place each animal below in the correct category? Give it a try!

Directions: Cut apart the animal pictures at the bottom of the page. Then paste them into the correct category on the animal coverings diagram.

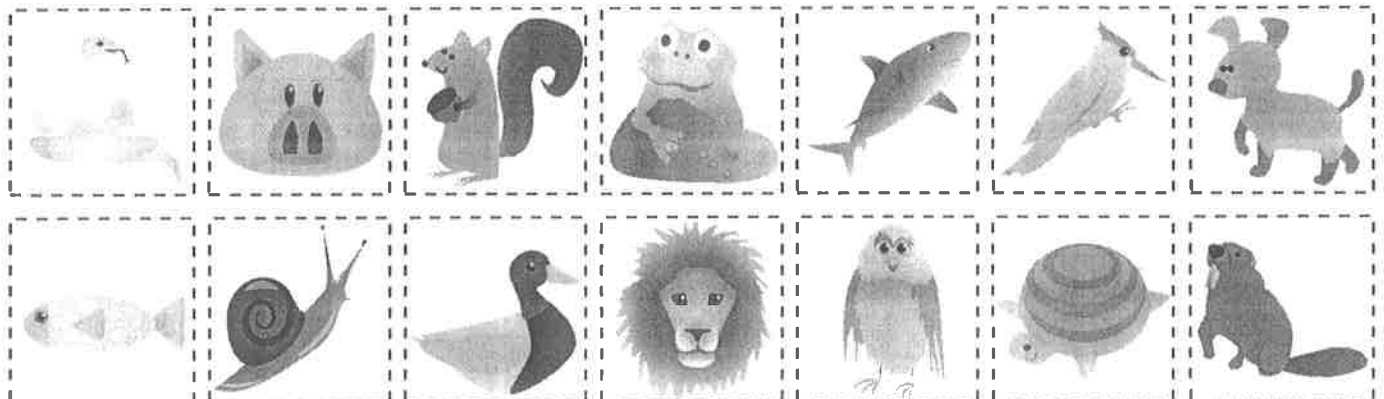
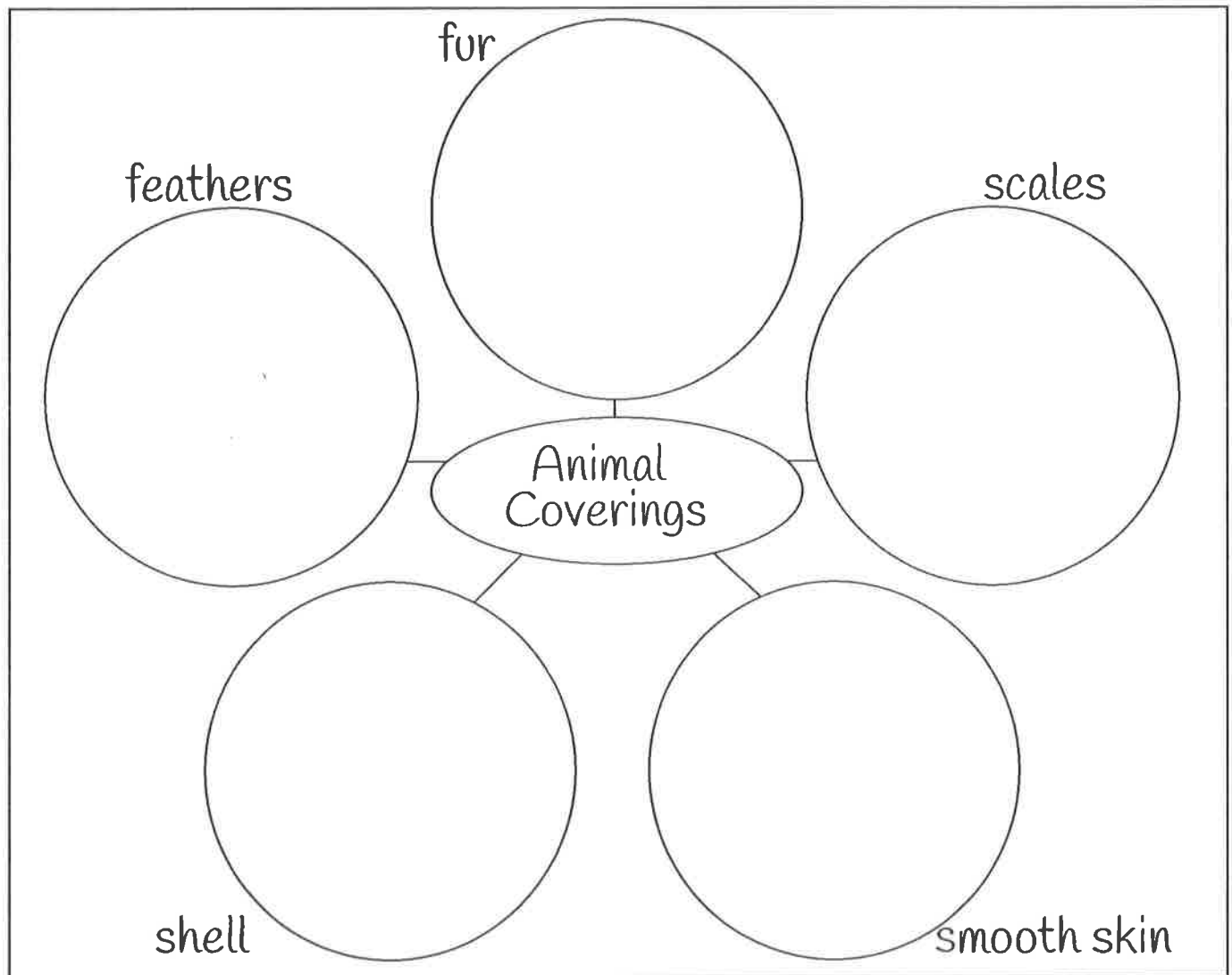

Benjamin Harrison



Write Harrison.

General Benjamin Harrison was the grandson of William Harrison, the 9th President. He became President 100 years after the very first President—George Washington.

The Facts 1889–1893

VP: Levi P. Morton

Party: Republican

State: Indiana

Married:

Caroline Scott (d. 1892);

Mary Dimmick

Lived: Aug. 20, 1833 –

March 13, 1901



What job was held by all three Presidents—Cleveland, Harrison, and McKinley?



William McKinley, Jr.

Write McKinley.

William McKinley was called the “Idol of Ohio.” He was assassinated just six months into his second term.

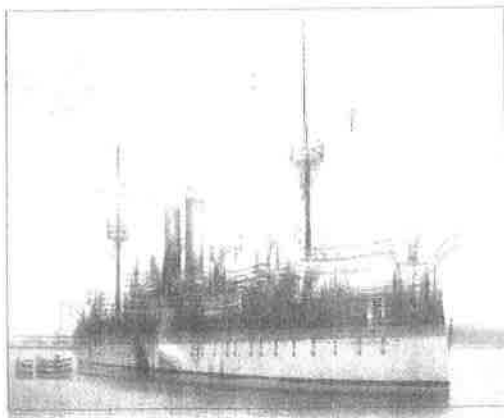

An explosion in 1898 that sank the U.S.S. Maine off the coast of Cuba was quickly blamed on Spain, launching the Spanish-American War.

BENDON WORKBOOKS

The Facts 1897–1901

VP: Garret A. Hobart;

Theodore Roosevelt

Party: Republican

State: Ohio

Married: Ida Saxton

Lived: Jan. 29, 1843 –

Sep. 14, 1901

McKinley's face is on the \$500 bill—which is no longer in circulation.

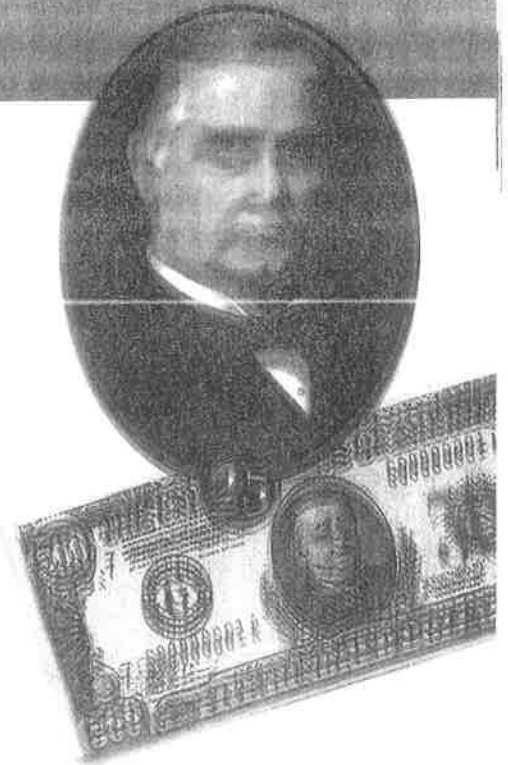

McKinley's pet parrot could whistle “Yankee Doodle.” Use the code to reveal its name.

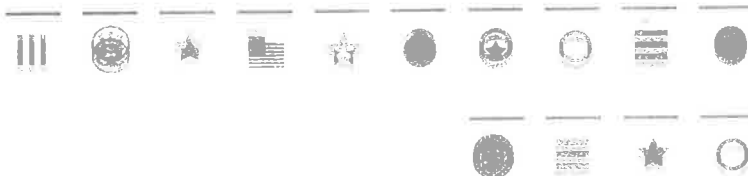

U.S. PRESIDENTS

Warren Gamaliel Harding



Write Harding.

At age 19, Warren Harding ran a newspaper. He was the first President to receive votes from women. He died in office, while traveling back from Alaska.

The Facts 1921–1923

VP: Calvin Coolidge

Party: Republican

State: Ohio

Married: Florence Kling

Lived: Nov. 2, 1865 –
Aug. 2, 1923

Harding was a radio fan! He had the first radio installed in the White House, and he was the first President to ever speak on the radio. Baltimore station WEAR broadcast his dedication at the Francis Scott Key Memorial site in 1922. Key wrote "The Star-Spangled Banner."

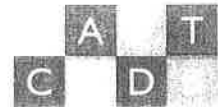

What day was Harding heard on the radio?

14



William Howard Taft



Write Taft.

William Taft—"Big Bill"—was the largest President: 6 feet tall, over 300 pounds. As President, he started the federal income tax.

The Facts 1909–1913

VP: James S. Sherman

Party: Republican

State: Ohio

Married: Nellie Herron

Lived: Sep. 15, 1857 –
March 8, 1930



What job did Taft hold after he was President?



7.